

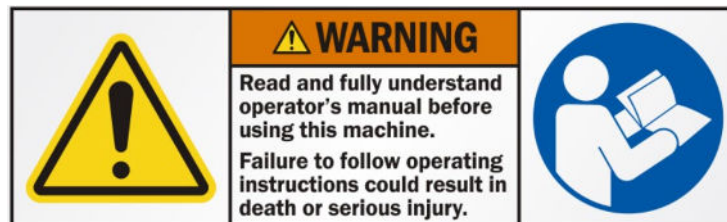

M-22 3 BAG MIXING STATION OPERATING MANUAL



Notice of Copyright Protection

Copyright 2020, by U.S.SAWS . All rights reserved. This work may not be reproduced or disseminated in whole or in part by any means without the prior written permission of U.S.SAWS

02-22-2022



INTRODUCTION & SPECIFICATIONS

1.0 INSTRUCTIONS FOR USE OF MANUAL SECTIONS

Section	Page
Table of Contents & Introduction	2
Symbols & Decals	3
Safety Instruction	4 - 5
Product Information	6 - 7
Operation	8 - 11
Warranty & Service	12 - 13

Foreword/Introduction

This manual outlines the maintenance and operation of the M-22 3 Bag Mixing Station. This is a professional tool and is intended for use by trained and experienced operators. To get maximum benefit from your tool and to ensure maximum safety, be sure to read this manual thoroughly. You should also periodically review safety instructions. Keep all manuals provided with your equipment in a safe place at all times.

The information and specifications included in this publication were in effect at the time of approval for printing. U.S.SAWS reserves the right, however, to discontinue or change specifications or design at any time without notice and without incurring any obligation.

The M-22 3 Bag Mixing Station is a compact, robust mixing station with good balance when pouring the self levelling compound, even with larger mixing volumes. The mixer unit is built with a 2-speed gearbox and variable speed setting allowing for quality control and mixing power. The M-22 is compactible with cement self-levelling and materials with good liquidity.

The unit comes complete with H27 mixer, 22 gallon bucket and transport dolly.

Disclosure

By purchasing/renting/borrowing/using the M-22 3 Bag Mixing Station, you agree to release U.S.SAWS of any and all liability. Under no circumstances will U.S.SAWS be held liable for incidental or consequential damages resulting from the use of this product and/or defective parts or products associated with this product.

- It is the responsibility of the owner/user to verify correct mixing ratio and proper cure before each use including after stoppage as explained in the operating instructions and in accordance to the material manufacturers guidelines and specifications.
- It is the responsibility of the owner/user to ensure that the operating instructions have been read and understood by the operator before the operation of the equipment begins.
- It is the responsibility of the owner/user to understand and perform the maintenance and storage procedures as explained in the operating instructions.

INTENDED USE:

The device is suitable for mixing of low-viscosity, self-leveling floor coatings, cement-based leveling and leveling compounds up to a quantity of approx. 70 liters.

- Observe the processing guidelines of the material manufacturer.
- The use of chemical products or solvents can affect the properties of the mixing tub and the machine.
- Check before use, whether the products to be mixed are compatible with the properties of the machine.
- The device is NOT suitable for processing food or highly viscous materials (e.g. concrete screed).

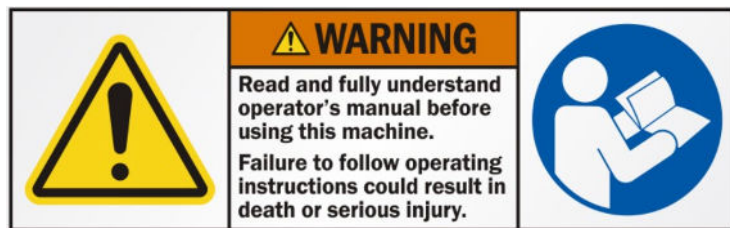

2.0 SPECIFICATIONS

Model	M-22 3 Bag Mixing Station
Part Number	SX20700
Power Supply	120V/60Hz
Motor power	1800W
Variable Speed	150-300 rpm 300-650 rpm
Empty weight	90 lbs
Container size	22 gallons
Mixed quantity	286 lbs



SYMBOLS & DECALS

3.0 SYMBOLS & DECALS

For Safe Operation

You must be qualified for safe operation of the U.S.SAWS M-22 3 Bag Mixing Station machine. You must clearly understand the written instructions supplied by U.S.SAWS, be trained - including actual operation - & know the safety rules & regulations for the job site. It is a safety practice to point out & explain safety signs & practices to others & to make sure they understand the importance of following these instructions.

Be Safe

Human error is the result of many factors: carelessness, fatigue, sensory overload, preoccupation, unfamiliarity with the machine or attachments, or drugs or alcohol, to name a few. You can avoid serious injury or death caused by these & other unsafe work practices. Be safe and never assume accidents cannot happen to you.

For your safety and the safety of others, act safely and encourage your fellow workers to act safely as well.



Read and understand operator's manual before using this machine. Failure to follow operating Instructions could result in injury or damage to equipment.

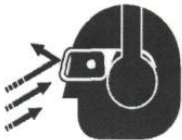

Always wear protective glasses or full face protection



Wear Head Protection, breathing protection, and the use of hearing protection is mandatory



Wear safety boots when operating this machine



Wear appropriate clothing



Wear hand protection



Wear proper electrostatic grounding equipment at all times.



Wear proper electrostatic grounding equipment at all times.

Dangers, Warnings and Cautions.

The purpose of safety symbols and explanations are to attract your attention to possible hazards and how to avoid them. The safety symbols and explanations do not by themselves eliminate any danger. The instructions or warnings they give are not substitutes for proper accident prevention measures.



DANGER: Indicates an imminently hazardous situation that if not avoided, will result in death or serious injury. This signal word is limited to the most extreme situations.



WARNING: Indicates a potentially hazardous situation that, if not avoided, could result in death or serious injury.



CAUTION: Indicates a potentially hazardous situation that, if not avoided may result in minor or moderate injury. It may also be used to alert against unsafe practices that may cause property damage.



SAFETY INSTRUCTIONS

4.0 SAFETY INSTRUCTIONS

4.1 KNOW THE RULES & YOUR EQUIPMENT.

Most job sites have rules governing equipment use & maintenance. Before starting at a new work location, check with the supervisor or safety coordinator. Ask about any rules or regulations you need to abide.

OSHA enforces federal laws within the United States that apply to the safe operation, application, & maintenance of equipment on job sites. It is the employer's responsibility to comply with these laws.

Do not operate this machine unless you have read the operations and maintenance manual carefully.

4.2 RECEIVE PROPER TRAINING.

Do not operate this machine unless you have received operational and maintenance training from a U.S. SAWS representative or from an authorized distributor for U.S.SAWS.

4.3 PROTECT YOUR FEET.

Observe all applicable local, state and federal safety regulations. Wear OSHA approved foot protection.

4.4 PROTECT YOUR EYES.

Observe all applicable local, state and federal safety regulations. Wear OSHA approved safety glasses.

4.5 PROTECT YOUR LUNGS.

Breathable silica may be generated by use of this product. Silica can cause severe and permanent lung damage, cancer, and other serious diseases. Do not breathe the dust. Do not rely on your sight or smell to determine if the dust is in the air. Silica may be in the air without a visible dust cloud. If air monitoring equipment for silica is not provided by your employer at your work site, you **MUST** wear appropriate respiratory protection when using or servicing the machine. Consult your employer and OSHA regarding the appropriate respiratory protection.

4.6 PROTECT YOUR HEARING.

Observe all applicable local, state and federal safety regulations. Wear OSHA approved hearing protection.

4.7 DRESS PROPERLY.

Do not wear loose clothing or jewelry that can be caught in moving parts. Wear protective hair covering to contain long hair. Keep hair away from motor air vent. Rubber gloves and non-skid footwear are recommended when working outdoors.

4.8 AVOID A DANGEROUS ENVIRONMENT.

Do not expose machine to rain. Do not use machine in wet conditions. Water entering a power tool will increase the risk of electric shock. Keep work area well lit. When working at an elevated location, pay attention to articles and persons below. If operating the power tool in damp locations is unavoidable, use a Ground Fault Circuit Interrupter (GFCI) protected supply. Use of an GFCI reduce the risk of electric shock.

4.9 ELECTRICAL SAFETY

Power tool plugs must match the outlet. Never modify the plug in any way. Do not use any adapter plugs with earthed (grounded) power tools. Unmodified plugs and matching outlets will reduce risk of electric shock. Avoid body contact with earthed or grounded surfaces such as pipes,

radiators, ranges and refrigerators. There is an increased risk of electric shock if your body is earthed or grounded.

4.10 ELECTRICAL CORD MANAGEMENT

Do not abuse the cord. Never use the cord for carrying, pulling or unplugging the power tool. Keep cord away from heat, oil, sharp edges or moving parts. Damaged or entangled cords increase the risk of electric shock. When operating a power tool outdoors, use an extension cord suitable for outdoor use. Use of a cord suitable for outdoor use reduces the risk of electric shock.

4.11 AVOID ANY AREAS OR ACTIONS THAT EXPOSE YOU TO CARBON MONOXIDE.

Exhaust gas from gasoline engines contains dangerous carbon monoxide. Breathing it can cause unconsciousness and even kill you. Always operate gasoline engine machines in a well-ventilated area. Do not operate in areas where exhaust fumes could accumulate without wearing appropriate respiratory protection. Consult your employer and OSHA regarding use of appropriate respirator for dangerous carbon monoxide gases.

4.12 KEEP WORK AREA CLEAN. DO NOT RUN OVER ANYTHING.

Loose objects could be thrown from crack. Make sure area to be cut is clear from people and any loose objects, nuts, bolts, etc. Never run over any loose objects.

4.13 KEEP CHILDREN AND VISITORS AWAY.

Do not let children or visitors contact machine or extension cord. Keep children and visitors away from the work area.

4.14 KEEP FIRM GRIP ON MACHINE.

During normal operation as instructed in Section 6.0, keep a firm hold on the handle grips and maintain control of the machine.

4.15 SHUT OFF MACHINE.

When not in use, before servicing and when changing accessories shut off engine.

4.16 STORE IDLE EQUIPMENT.

The machine and tools should be stored in a dry and secure location when not in use. Keep equipment out of reach of children.

4.17 OBTAIN SAFETY DATA SHEET (SDS) FOR ALL WORK SURFACE MATERIALS.

This includes primers, all coatings, adhesives, tile and crack filling materials, etc. Do not attempt to cut, clean out or remove material without SDS information. Consult SDS sheet for hazards information. Be aware that some materials are explosive as a dust.

4.18 DO NOT OVERREACH.

Keep proper footing and balance at all times.

4.19 MAINTAIN MACHINE WITH CARE.

Keep machine clean and follow maintenance procedures for better and safer performance. Keep handles dry, clean, and free from oil and grease. Follow instructions for lubricating and changing accessories.



SAFETY INSTRUCTIONS

4.20 REMOVE ADJUSTING TOOLS.

Form a habit of checking to see that tools such as adjusting wrenches are removed from the machine and properly stored before starting the engine.

4.21 STAY ALERT.

Watch what you are doing. Use common sense. Do not operate machine when you are tired or fatigued.

4.22 DO NOT USE DRUGS, ALCOHOL, MEDICATION.

Do not operate machine while under the influence of drugs, alcohol, or any medication.

4.23 KEEP THE RIGHT PARTS IN THE RIGHT POSITIONS.

Do not operate machine with parts missing or improperly mounted.

4.24 CHECK DAMAGED PARTS.

Verify all machine guards are in good condition and will function properly before using the machine. Check for alignment of moving parts, binding of moving parts, breakage of parts, mounting, and any other conditions that may affect machine operation. A guard, power switch or other part that is damaged should be properly repaired or replaced by an authorized service center unless indicated elsewhere in this instruction manual. Do not operate machine if lever or engine on/off switch does not function properly.

4.25 SECURELY MOUNT ACCESSORIES TO THE MACHINE.

Extra care must be taken at an elevated location to prevent injury to someone on a lower level in the event the tool or accessory should drop. Do not operate without fall protection for operator and debris protection for public.

4.26 NEVER TOUCH THE MOVING PARTS.

Never touch moving parts such as blades, belts and others.

4.27 STOP OPERATION IMMEDIATELY IF ANY ABNORMALITY IS DETECTED.

Stop using machine immediately if any abnormalities are observed during operation. Examples of abnormalities include unusual noise and vibration.

4.28 WHEN REPLACING A PART, USE THE SAME TYPE AND QUALITY.

When replacing a component part with a new one, use only the same type and quality of new part. Never attempt to repair a machine if you are unfamiliar with proper procedures and techniques required.

4.29 LOAD AND UNLOAD SAFELY.

Use proper heavy lifting procedures. Read & understand manuals before loading & unloading.

4.30 SAVE THESE INSTRUCTIONS.

Refer to this operations and maintenance manual as well as any additional instructions included from other manufacturers and organizations such as Honda® and the Masonry and Concrete Saw Manufacturers Institute®. Never permit anyone to operate the machine without proper instructions.



DUST WARNING

Cutting, especially when DRY cutting, generates dust that comes from the material being cut, which frequently contains silica.

Silica is a basic component of sand, quartz, brick clay, granite and numerous other minerals and rocks. Exposure to excessive amount of such dust can cause:

- Respiratory diseases (affecting your ability to breath), including chronic bronchitis, silicosis and pulmonary fibrosis from exposure to silica. These diseases may be fatal;
- Skin irritation and rash; and
- Cancer according to NTP* and IARC*

* National Toxicology Program, International Agency for Research on Cancer

Take precautionary steps

- Avoid inhalation of and skin contact with dust, mist and fumes;
- Wet cut when feasible, to minimize dust;
- Wear and ensure that all bystanders wear appropriate respiratory protection such as dust masks designed to filter out microscopic particles. (See OSHA 29 CFR Part 1910.1200)

California Prop 65 Warning: Use of this product can cause exposure to materials known to the State of California to cause cancer and/or birth defects or other reproductive harm.



PRODUCT INFORMATION

5. PRODUCT INFORMATION

5.1 SPECIFICATIONS

Stirring device	R1900	R1800
Order-No.	111 252 100	111 252 550
Power Supply	230 V	120 V
Motor Power	1900 W	1800 W
Speed	1 gear: 150-300 rpm 2 gear: 300-650 rpm	
Tool holder	M 14	
Stirrer / Ø	H27 / 300 mm	
Weight	8,0 kg	
Protection class	II /	

Stirring Station	CLEVER
Dimensions	720 x 570 x 1120 mm
Capacity	85L
	4 bags levelling compound à 25 kg corresponds to approx. 60 L mixing quantity ≅ approx. 130 kg
Empty weight	41 kg

5.2 APPLICATION

Compact, robust mixing station with good balance when pouring the self levelling compound, even with larger mixing volumes.

*Suitable mixing materials

Mainly for cement self-leveling, and materials with good liquidity.

Mixer with 2-speed gearbox and infinitely variable speed setting.

5.3 STANDARD ACCESSORIES

Comes complete with special stirrer H27 and mixing bucket 85 L.

1 x Special stirrer H27 Order-No. 111 252 050
1 x Mixing bucket 85 L Order-No. 111 253 150
2 x wrenches-for mounting the stirrer
4 x stop nuts for wheel mounting

5.3 STANDARD ACCESSORIES

Comes complete with special stirrer H27 and mixing bucket 85 L.

1 x Special stirrer H27 Order-No. 111 252 050
1 x Mixing bucket 85 L Order-No. 111 253 150
2 x wrenches-for mounting the stirrer
4 x stop nuts for wheel mounting

5.4 CONTROL ELEMENTS

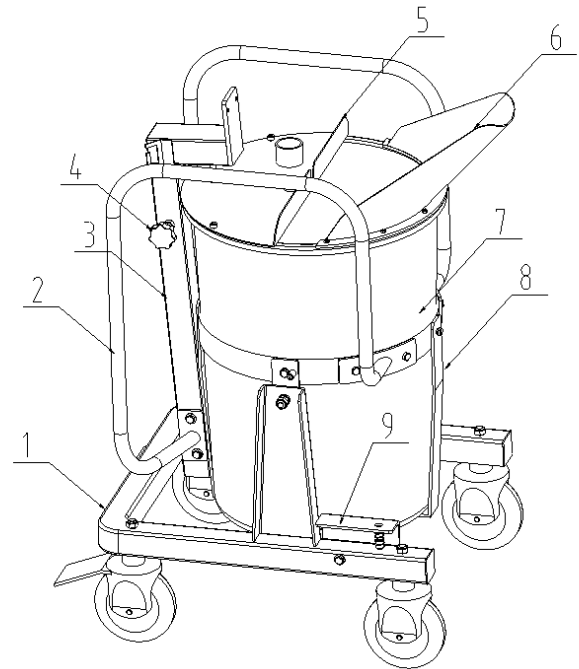

No.	Part list
1	Base bracket
2	Operating handle
3	Support tube
4	Plum blossom knob
5	Dust cover plate (optional)
6	Pour material mouth
7	Mixing barrel
8	Barrel hoop
9	Pedals



PRODUCT INFORMATION

6. PREPARATION

STEP 1

WHEEL MOUNTING

As shown in FIG 1,

- 2 x wheels with brake at th back
- 2 x wheels with no brake at the front

Use locking nuts to mount and fix the wheels

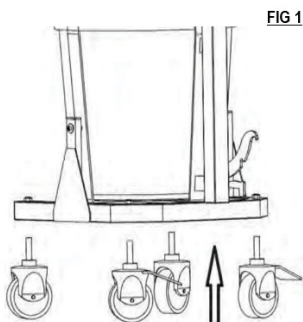

STEP 2

FIX THE MIXING STATION as shown in FIG 2,

Press down the pedal of the universal wheel to lock the wheels.

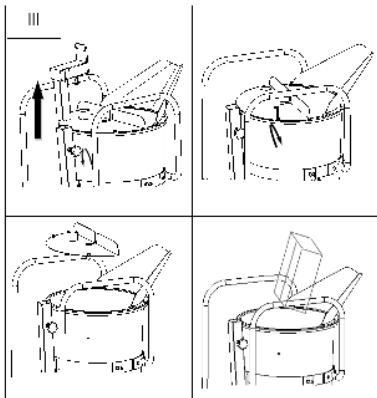
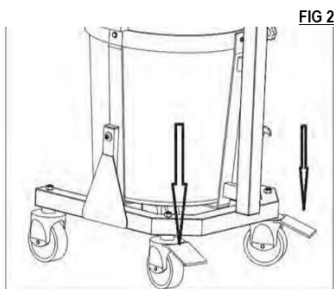

STEP 3

1. Disassemble the junction plate firstly,
2. Disassemble the dust over by the socket head wrench,
3. Take outer the mixer carton from the barrel.

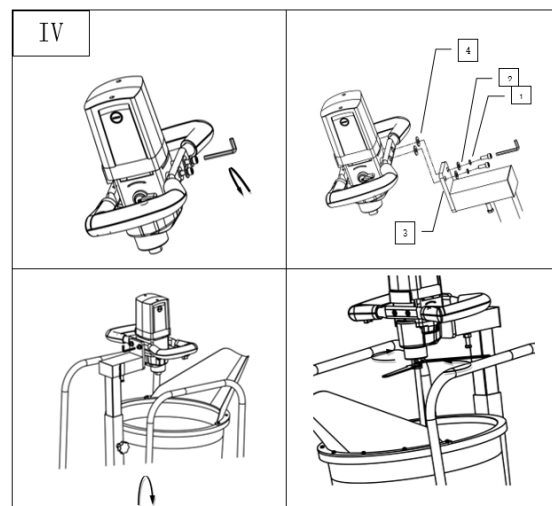

STEP 4 As shown in figure IV

1. Take out the inner hexagon screw from the mixer,
2. Assemble the mixer to the junction plate in order of 1~4 as shown in the diagram and tighten by the socket hexagon wrench.(1-φspring washing, 2-φfalt washing, 3-junction plate, 4-2mm washer).
3. Put back the junction plate with mixer to the station, tighten the knob.
4. Install the paddle to the mixer, use the open-end wrench to lock the mixing paddle and the mixer in the direction shown

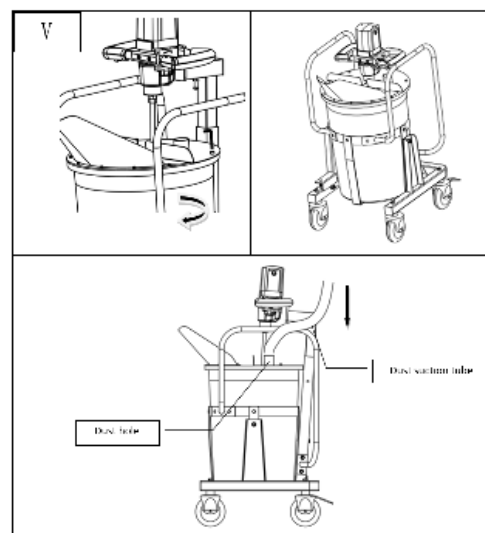

STEP 5 As shown in figure V

1. Put back the dust cover as the figure shows, tighten the screws by the socket head wrench.
2. Connect the dust hole of the mixing station with the dust suction tube of the external vacuum cleaner in the direction of the arrow.



OPERATION

7. OPERATION

7.1 INSTRUCTIONS FOR SAFE USE

Safe work with the instrument is only possible after you read thoroughly this manual for use and maintenance and observe precisely the here specified instructions.

Observe also other safety directions that are a part of each instrument delivery.

PERSONAL PROTECTION

- Wear work clothes and the recommended protective equipment.
- Take care of long hair and fashion accessories, work in properly buttoned garments without free-flowing parts.
- Take care that take a safe and firm stand at work.
- Use the supplementary handle
- Consider possible reaction torque.

WORKING ENVIRONMENT

- Check the Instrument should not be operated in clamp, wet premises, during a rain, fog and snow in the open, and in environment with a risk of explosion.
- Ensure that the mixing station is placed in a firm and secure position. A mixing station that is not properly secured may move unexpectedly.
- Take protective measures when dust can develop during working that is harmful to one's health, combustible or explosive. Example: Some dusts are regarded as carcinogenic. Wear a dust mask and work with dust extraction.

ELECTRICAL SAFETY

- If the mixer falls into the material to be mixed, unplug the tool immediately and have the mixer checked by a qualified repair person. Reaching into the mixing container with the tool still plugged in can lead to electric shock.

SECURITY AGAINST UNINTENDED START

- Before putting the plug in the mains socket the switch should be in the "off" position.
- Turn off the machine if it stops for any reason. In this way you avoid the sudden start in the unattended condition.

MATERIAL

- Follow the instructions and warnings for the material to be mixed. Material to be mixed can be harmful.
- Avoid splashing mixed material.
- Do not work with materials containing asbestos. Asbestos is considered carcinogenic.

WORK PROCEDURE

- The mixer must be firmly fixed.
Loss of control can cause personal injury.
- Ensure sufficient ventilation when mixing flammable materials to avoid a hazardous atmosphere. Evaporative gas may be inhaled or be ignited by the sparks the mixer produces.
- Keep the cord away from the working area. Always direct backwards the cord from the device The cord should not be exerted by tensile stress and should not lie on or pass over sharp edges.
- Never let the device mix unsupervised. Pull the mains plug and check that the switch is switched off if the mixer is left unattended, e.g. during assembly and dismantling work, in the event of a voltage drop, when inserting or installing an accessory.
- When parking and stirring the mix, the device must always be secured using the two castors with brake.
- Ensure that no liquid splashes against the housing of the mixer. Liquid that has penetrated the mixer can cause damage and lead to electric shock.
- Do not reach into the mixing container with your hands or insert any other objects into it while mixing. Contact with the stirrer may lead to serious personal injury.
- Make sure that the cable is not tangled by the stirrer.
- Do not reach into rotating parts.
- Do not reach into the container with long objects.
- Take material samples only when the device is at a standstill and the mains plug is pulled.



OPERATION

7.2 STARTING OPERATION AND USE

Improper use may damage the device.

Observe therefore these instructions:

- Use a stirrer up to the specified diameter max Ø 300 mm.
- Load the device in such a way that the speed would not drop considerably or that it would stop.

Check if the data on the rating plate correspond with the actual mains voltage. The device scheduled for 230V can be plugged to 220V/240V mains.

7.2.1 Fixing a stirrer:

Screw tools with thread M14X2 as far as possible in the tool mount and tighten properly with an open-end wrench (22mm) from among the accessories.

7.2.2 Switching on and off:

By pressing the switch button the device is brought into operation and it stop when is relieved.

7.3.3 Permanent run:

By pressing the switch button o the stop and simultaneous pressing the arresting pin permanent run is achieved. By subsequent pressing and relieving of the switch button the permanent run is interrupted.

7.3.4. Remove the stirrer:

Fit a flat open-end wrench (22mm) on the hexagon end of the tool (whisk) and unscrew the tool from the spindle by turning it to the left.

7.3 ELECTRONIC MOTOR CONTROL

7.3.1 Starting current limiting:

The electronically controlled smooth start takes care that the machine starts without jerk. In this manner, the splashing of thin liquid materials is prevent at the same time when switching on the machine. As a result of the machine's reduced starting current, a 16A fuse is sufficient

7.3.2 No-load speed reduction:

The electronic control reduces the no-load speed of the machine which results in reduced noise and wear of motor and gear.

7.3.3 Speed pre-selection:

With the speed control, the speed can be continuously pre-selected. The necessary speed is dependent on the type of material to be mixed. It is recommended that it be confirmed. With a practical trial.

7.3.4 Speed selection

Two rpm ranges can be preselected with the speed selector switch (6).

Speed 1: 150 min – 300 rpm

Speed 2: 300 min – 650 rpm

The necessary speed depends on the type of the material mixed and it is recommended to verify it by practical test.

7.3.5 Constant Electronics

The constant electronic keeps the Speed between no-load and load nearly constant and ensure uniform mixing of the materials.

7.3.6 Electronic overload protection:

In case that the machine is extremely overloaded, an electronic overload protection protects the motor from damage. In this case, the motor stops and restarts only after the feeding pressure is reduced.

7.3.7 Temperature-dependent overload protection

To protect the motor from overheating at extreme permanent load, it is switched off by the protective electronic system when a critical temperature is reached. After a cooling-down period of approx. 3-5 min. the machine is again ready for use and can be fully loaded.

When the machine is warmed by use, the temperature-dependent overload protection reacts earlier as a result.



OPERATION

7.4 MIXING PROCESS

BEFORE MIXING PROCESS

- Lock the lifting arm firmly on the chassis.
- Secure the transport rollers using the parking brake.

MIXING PROCESS

- Always pour water into the mix first
- Always start the device when it is empty or only filled with water
- Fill the mix through the opening while the machine is running.
- Depending on the material, start at a low speed and increase the speed after all components have been filled
- Place the device on an even ground.

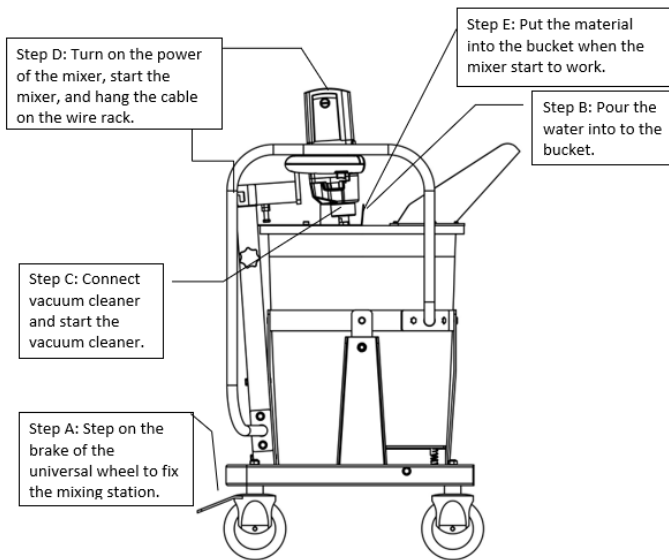

As shown in figure below follow the steps to complete the operations from A to D in sequence to complete the mixing operation of the mixing station.

7.5 POUR OUT MIXTURE

DISCONNECT THE PLUG BEFORE POURING OUT

Lock the cable on the cover in the cable holder.

- Release the brake on the transport wheels.
- Move the device to the pouring point using the handle and lifting arm.
- To tip over push the release pedal with your foot
- Tilt the mixing bucket forward on the handle until the mix flows over the pourer.
- To distribute the mixture, drive the device in the desired direction.
- To keep the wheels clean, always drive away from the poured mixture.

Always hold the handles firmly with both hands.

NEVER LIFT MIXING BUCKET IN FILLED CONDITION OUT OF THE CHASSIS!!

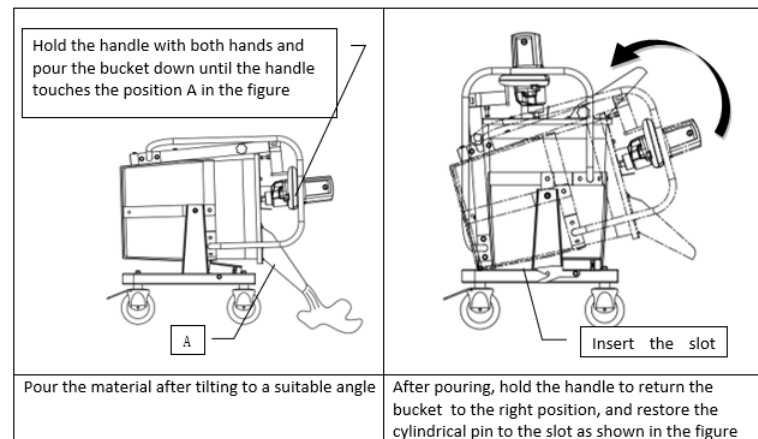
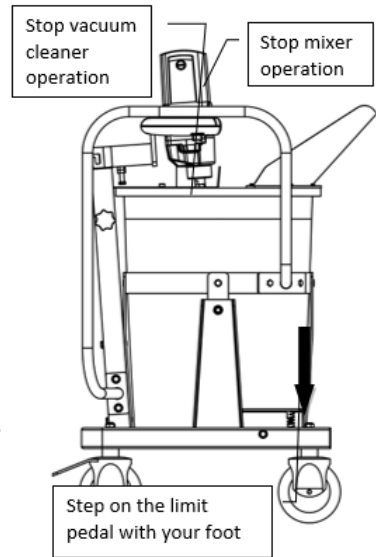

OPERATION

8 TRANSPORT

The device can be moved effortlessly thanks to the four stable transport rollers. To prevent unintentional rolling away, two castors can be secured with a brake.

9 STORAGE

The unit should be stored in a dry place where it is protected against freezing.

10 DISPOSAL

Do not open worn out machines and return to the collection facilities for recycling.

11 MAINTENANCE

-The ventilation slots on the motor casing should be cleaned out from time to time.

- When the carbon brushes are worn out, the machine switches itself off. The machine must then be sent to customer services for maintenance (see enclosed sheet)

-After approx. 100 hours of operation, check the motor brushes and replace if necessary. Clean the motor housing.

-After approx. 200 hours of operation, renew the grease filling in the gearbox.

To verify that the protective insulation remains intact machine must be subjected to a technical safety test afterwards. For this reason, this work must be performed exclusively by a professional electro - electro-workshop.



WARRANTY AND SERVICE

9.0 WARRANTY AND SERVICE

9.1.1 Warranty

This document is to be used as a guide in determining warranty policies and procedures for U.S.SAWS and its U.S.SAWS products. It is to be used in determining whether a warranty is justified and as a procedural guide in completing a U.S.SAWS warranty claim form.

9.1.2 Warranty Responsibility

The distributor or the end user must prepare a Machine Warranty Information Card when the machine is delivered. Failure to comply will make any and all warranties on this equipment null and void. Credit for warranty repairs will be given only after receipt of the WARRANTY CLAIM FORM, properly completed with all the required details. Submittal details are described later in this document.

9.1.3 Warranty Policy

9.1.3.1 U.S.SAWS warrants its U.S.SAWS products against defects in material and workmanship under normal and proper use for a period of one year (365) days from the date of delivery; in the case of Rental Fleet Machines, date of assignment to Rental Fleet. Such warranty is extended only to the buyer who purchases the equipment directly from U.S.SAWS or its authorized distributor. This warranty does not include expendable parts such as, but not limited to, plugs, cutters, blades, blast wheel, wear parts, liners and seals.

9.1.3.2 The obligation under this warranty is strictly limited to the replacement or repair, at US SAWS's option, of machines and does not include the cost of transportation, loss of operating time, or normal maintenance services.

9.1.3.3 This warranty does not apply to failure occurring as a result of abuse, misuse, negligence, corrosion, erosion, normal wear and tear, alterations or modifications made to the machine without express written consent of U.S.SAWS .

9.1.3.4 Warranty request must be submitted in writing within thirty (30) days after failure.

9.1.3.5 Written authorization to return merchandise under warranty must first be obtained from U.S.SAWS .

9.1.3.6 U.S.SAWS reserves the right to inspect and make the final decision on any merchandise returned under warranty.

9.1.3.7 U.S.SAWS offers no warranty with respect to accessories, including but not limited to, engines, motors, batteries, electrical boards, tires and any other parts not manufactured by us but which the original manufacturer warrants.

9.1.3.8 U.S.SAWS reserves the right to make product changes or improvements without prior notice and without imposing any obligation upon itself to install the same on its products previously sold.

9.1.3.9 The above warranty conditions can only be altered by US SAWS. US SAWS must confirm alterations in writing for each specific transaction.

9.1.3.10 U.S.SAWS reserves the right to establish specific warranty terms for used or demo machines on an individual transaction basis. Invoices covering such merchandise will clearly state the provisions of the applicable warranty for each specific transaction.

9.1.3.11 WE DO NOT AUTHORIZE ANY PERSON, REPRESENTATIVE OR SERVICE OR SALES ORGANIZATION TO MAKE ANY OTHER WARRANTY OR TO ASSUME FOR US ANY LIABILITY IN CONNECTION WITH THE SALE OF OUR PRODUCTS OTHER THAN THOSE CONTAINED HEREIN.

9.1.3.12 UNDER NO CIRCUMSTANCES SHALL US SAWS BE LIABLE TO CUSTOMER OR ANY OTHER PERSON FOR ANY DIRECT, INCIDENTAL, OR CONSEQUENTIAL DAMAGES RESULTING FROM THE USE OF THE PRODUCT OR ARISING OUT OF ANY BREACH OF ANY WARRANTY OR FOR ANY SPECIAL OR CONSEQUENTIAL DAMAGES OF ANY CHARACTER, INCLUDING WITHOUT LIMITATIONS, DAMAGES FOR ANY LOSS OF GOODWILL, WORK STOPPAGE, OR ANY AND ALL OTHER COMMERCIAL DAMAGES OR LOSSES.

9.1.3.13 U.S.SAWS MAKES NO OTHER WARRANTIES, EXPRESSED OR IMPLIED, INCLUDING, BUT NOT LIMITED TO, THE IMPLIED WARRANTIES OF MERCHANTABILITY AND FITNESS FOR A PARTICULAR PURPOSE WITH RESPECT TO THE US SAWS PRODUCTS SOLD PURSUANT THERETO.



MACHINE WARRANTY INFORMATION CARD

TO ENSURE THE PROPER WARRANTY COVERAGE IS EXTENDED TO THE OWNER OF THIS MACHINE, FILL OUT THE ATTACHED CARD COMPLETELY AND ACCURATELY.

WARRANTY REGISTRATION CARD

IMPORTANT! To ensure that your U.S.SAWS machine is covered under warranty, please fill in the following information and mail or fax it to U.S.SAWS, 8004B E. Broadway Ave. Tampa, FL 33619, Fax No. (813) 621-7125

COMPANY
NAME
ADDRESS
INTENDED USE
DATE OF PURCHASE
INTENDED USE
SERIAL NUMBER

If you are not the owner of record as shown on the manual copy of the warranty registration card, do not operate this machine before contacting U.S.SAWS at 1-877-817-6687. Verify the following before operating the equipment:

CHANGE OF OWNER OR NEW ADDRESS REGISTRATION CARD

IMPORTANT! To ensure that your U.S.SAWS machine is covered under warranty, please fill in the following information and mail or fax it to U.S. SAWS, 8004B E. Broadway Ave. Tampa, FL 33619, Fax No. (813) 621-7125

COMPANY
NAME
ADDRESS
INTENDED USE
DATE OF PURCHASE
INTENDED USE
SERIAL NUMBER

13

U.S.SAWS™

**SURFACE PREP
DIVISION**

P: 877-817- 6687 F: 813-621-7125
Visit us at www.ussaws.com
sales@ussaws.com

